

Magic Eraser

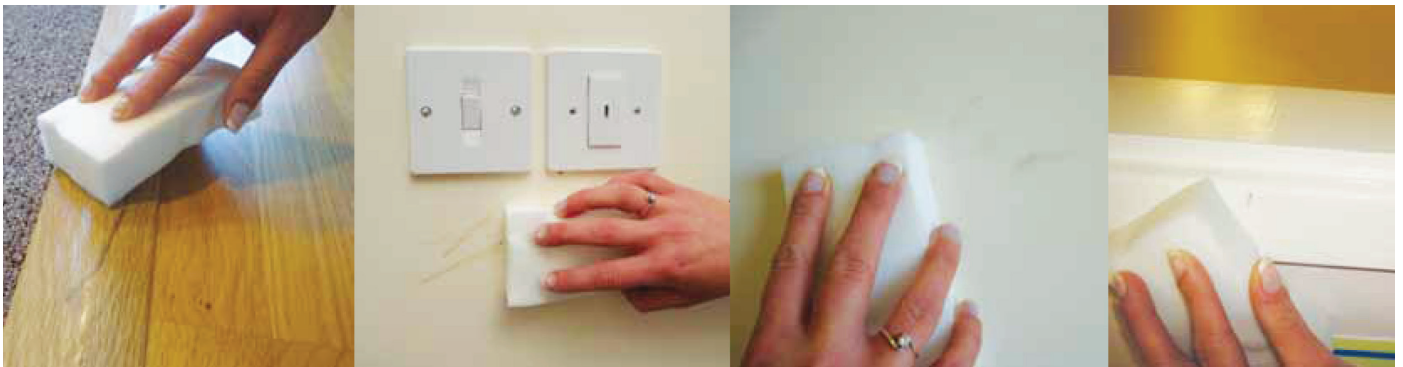

Removes scuff marks on floors, Marks around light switches, Finger prints on walls, Ground in marks on floors

Unika's Magic Eraser is a brand new cleaning product which will lift tough dirt, stains and marks from virtually any surface – ceramics, plastics, steel, mirrors, glass, flooring, walls etc.

Use on:

Scuff marks on floors, skirting boards and doors

Grime that has built up on bathroom fittings – basin, toilet, bath

Black marks that appear on white UPVC double glazing, outside garden furniture.

Marks on kitchen appliances – cooker, fridge, stainless steel sinks etc.

Magic Eraser is flame retardant so it can be used on hot surfaces like cooker tops.

Other uses: stained cups and mugs, marks on vinyl flooring, car dashboards, burnt on food on cookware, light switches...

... what will you use yours for?!

Magic Eraser is made from a special lightweight melamine resin foam that penetrates deep into the surface grooves and breaks up the dirt and lifts them from the surface with just water. No detergents are required - so making it environmentally friendly.

Directions for Use:

1. Place Magic Eraser under tap and squeeze out excess water leaving the sponge damp.
2. Rub gently over the mark/stain to loosen dirt and lift it away.
3. Magic Eraser can be used a number of times but after several uses the sponge will become worn and reduced in size, this is when it is ready to throw away and to start with a new sponge.
4. You can cut the Magic Eraser to any size so that for example you have a sharper point for getting into deep grooves. Or you may simply want to trim off the blackened edges.



New Magic Eraser



Several Uses - Discard

UNIKA COLOR PRODUCTS LTD

Unika House, New York Way, New York Industrial Park, Newcastle upon Tyne, U.K. NE27 0QF

Telephone: +44 (0) 191 259 0033

Fax: +44 (0) 191 257 4525

Email: sales@unika.co.uk www.unika.co.uk

